

- ✓ RIGHT PRODUCTS
- ✓ RIGHT PLACE
- ✓ RIGHT TIME

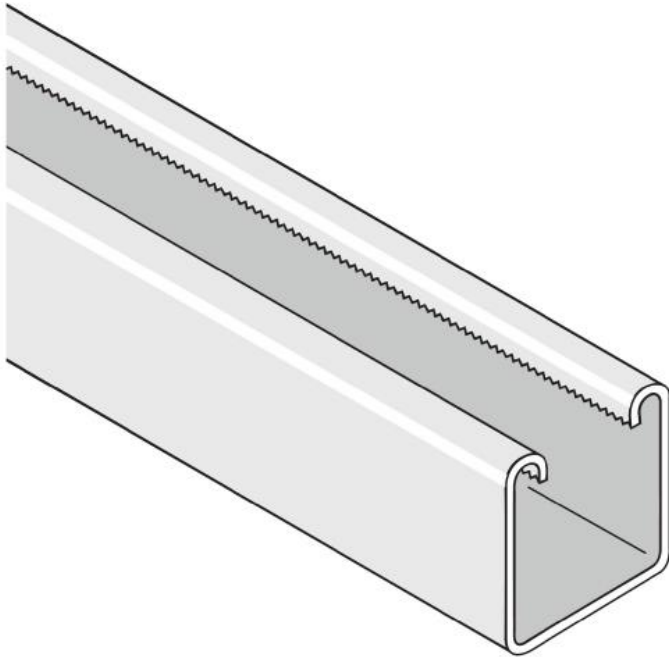

Plain Channel, 41 x 41, 2.5mm

Plain Channel, 41 x 41, 2.5mm in Pre Galvanised (PG) and Hot Dipped Galvanised (HDG) finish. Available in 3m and 6m lengths.

Manufactured from mild steel (S280GD) to BS 6946.

These standard duty channel sections have been designed to provide a versatile and economical solution to industrial framing and support problems.

Technical data supplied by the manufacturer.

Description

Dimensions: 41 x 41, 2.5mm

Lengths: 3m and 6m

Material: Mild Steel

Finish: Pre Galvanised (PG) or Hot Dipped Galvanised Steel (HDG).

- Channel manufactured to comply with BS 6946 from Mild Steel (S280GD) with a minimum yield stress of 280N/mm²
- Hot Dipped Galvanised (HDG) 55 Micron finish to BS EN ISO 1461
- Pre Galvanised (PG) BS EN 10346 Zinc coating Z275

Remark: This technical data sheet replaces all previous versions. The technical data contained herein is given in good faith and we cannot be held liable for any errors, inaccuracies, omissions or editorial failings. The information detailed in this technical data sheet is given by way of indication and is not exhaustive, users should contact either the seller or the manufacturer of the product for additional technical information concerning its use, if they think the information in their possession needs to be clarified in any way. Any illustrations shown are indicative only, and dimensions may differ slightly from batch to batch.

MEP & HVAC FIXING SPECIALISTS

Springhead Enterprise Park, Springhead Road, Northfleet, Kent DA11 8HJ
 T 01322 274226 F 01322 278178 E sales@fixmart.co.uk www.fixmart.co.uk

- ✓ RIGHT PRODUCTS
- ✓ RIGHT PLACE
- ✓ RIGHT TIME

Product Information Table - 3m Length

Span or Column Unsupported High (mm)	Uniform Load @ 175NN/mm ² Stress (kg)	Deflection (mm) at 175NN/mm ²	Uniform Load at Max. Deflection of 1/200 th Span (kg)	Uniform Load at Max. Deflection of 1/360 th Span (kg)	Max. Load of Column Loaded @ Centroid (kg)	Max. Load of Column Loaded @ Slot Face (kg)
C250	1769	0.23	-	-	5869	1693
500	884	0.95	-	-	5379	1650
750	589	2.15	-	571	4479	1554
1000	442	3.82	-	321	3373	1395
1250	353	5.97	-	205	2556	1232
1500	294	8.6	257	142	2020	1093
1750	252	11.7	188	104	1656	976
2000	221	15.29	144	80	1395	879
2250	196	19.35	114	63	1198	797
2500	176	23.89	92	51	1044	725
2750	160	28.91	76	42	(919)	(663)
3000	147	34.4	64	35	(816)	(607)

Remark: This technical data sheet replaces all previous versions. The technical data contained herein is given in good faith and we cannot be held liable for any errors, inaccuracies, omissions or editorial failings. The information detailed in this technical data sheet is given by way of indication and is not exhaustive, users should contact either the seller or the manufacturer of the product for additional technical information concerning its use, if they think the information in their possession needs to be clarified in any way. Any illustrations shown are indicative only, and dimensions may differ slightly from batch to batch.

MEP & HVAC FIXING SPECIALISTS

Springhead Enterprise Park, Springhead Road, Northfleet, Kent DA11 8HJ
 T 01322 274226 F 01322 278178 E sales@fixmart.co.uk www.fixmart.co.uk