

Assembly Set MS 5P

Group: A640

Application

Element for connecting Beam Bracket TKO, Angled Beam Bracket SKO, End Support WBD or Pivot Joint GE F to a beam section.

Scope of delivery

Type	Beam Clip [Quantity]	Support plate [Quantity]	HR trimming * [Quantity]
M12 S	4 x M12	4 x M12	4 x M12 x 80
M16 S	4 x M16	4 x M16	4 x M16 x 100
M12 S2	2 x M12	2 x M12	2 x M12 x 80

* HR trimming according EN 14399-3 consisting of: Hexagon bolt M12 or M16, 2 washers, 1 hexagon nut

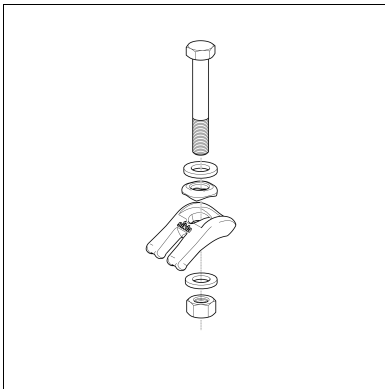

Installation

1. Position Beam Clip with the split end on beam section.
2. Install support plate and HR trimming and tighten accordingly.

The support plate secures a rectangular assembly of the bolt and prevents its shifting or bending stress. In conjunction with the HR trimming a continuous and predictable preload force is guaranteed.

Technical Data

Type	Size range [mm]	Tightening torque M_A [Nm] / Weiterdrehwinkel	F_y perm. per Beam Clip [kN]	Shear force load capacity F_z per set = 4 Beam Clips kN]
M12 S	1 - 30	60 / 90°	26,3	12,0 *
M16 S	4 - 40	140 / 90°	32,0	13,6 *

* The specified data relate to the worst case with flange thicknesses 30 mm (M12) or 40 mm (M16) as well as a coefficient of adhesion $\mu_{adhesion} = 0,20$. A possibly operating tensile force F_y isn't included.

Material: Steel, HCP

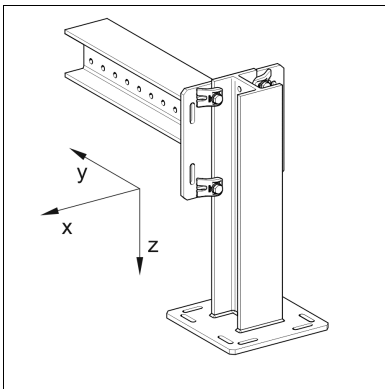

Type	W [kg]	Qty. [set]	Part number
M12 S	1.2	10	115843
M16 S	2.2	10	115844
M12 S2	0.6	10	115845

