

Channel Nuts

Plain Channel Nuts

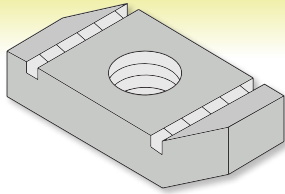

BRIGHT ZINC PLATED (BZP)

CODE	SIZE	BOX QTY
2014 01101	M6	100
2014 01103	M8	100
2014 01105	M10	100
2014 01107	M12	100
2014 06195	M16	100

HOT-DIP GALVANISED (HDG)

CODE	SIZE	BOX QTY
2014 01102	M6	100
2014 01104	M8	100
2014 01106	M10	100
2014 01108	M12	100

Short Spring Channel Nuts

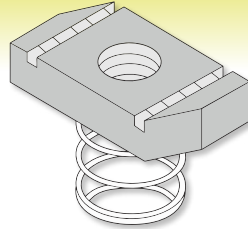

BRIGHT ZINC PLATED (BZP)

CODE	SIZE	BOX QTY
2014 01109	M6	100
2014 01111	M8	100
2014 01113	M10	100
2014 01115	M12	100

HOT-DIP GALVANISED (HDG)

CODE	SIZE	BOX QTY
2014 01110	M6	100
2014 01112	M8	100
2014 01114	M10	100
2014 01116	M12	100

Short Spring Channel Nuts

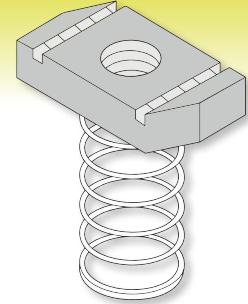

BRIGHT ZINC PLATED (BZP)

CODE	SIZE	BOX QTY
2014 01093	M6	100
2014 01095	M8	100
2014 01097	M10	100
2014 01099	M12	100

HOT-DIP GALVANISED (HDG)

CODE	SIZE	BOX QTY
2014 01094	M6	100
2014 01096	M8	100
2014 01098	M10	100
2014 01100	M12	100

TECHNICAL DATA

Steel Minimum Yield Stress:	275N/mm ²
	Minimum coating thickness
Bright Zinc Plated (BZP)	5µm
Hot-Dip Galvanised (HDG)	55µm

Size	Tightening Torque (NM)	Max Safe Load 1. (F kN)	Max Safe Load 2. (F kN)
M6	12	1.57	4.30
M8	28	2.20	4.70
M10	55	3.61	6.22
M12	60	4.18	7.96
M16	125	5.92	10.29

MAXIMUM SAFE LOADS

Loads apply to channel nuts assembled with:

1. 2.5mm Thick Channel
2. 5mm Thick Square Plate Washer
3. Grade 8.8 Fastener
4. Torque settings, as indicated in above table

